



FIRST THINGS FIRST, YOU NEED TO KNOW WHAT'S IN THE BOX YOU JUST OPENED:

- a Steam Bottle with Direct Steam Nozzle
- b Extension Hose
- c Flat Scrubber Attachment with 2 Bonnets
- d Grout Scrubber Brush
- e Shower Door Squeegee
- f Filling Flask
- g Nozzle Cleaning Tool

Your portable steam cleaner is designed to clean surfaces that will withstand high heat and moisture. Do not use on unsealed wood surfaces (especially wooden antique furniture), unglazed ceramic tile, painted surfaces or surfaces that have been treated with wax, oils, varnishes, or shellac. The sheen may be removed by the heat, steam, and friction of the cleaning tools. Lacquer and polyurethane coatings provide a hard durable protective finish that withstands moisture but it is always recommended to test an isolated area of the surface to be cleaned before proceeding. We also recommend you check the use and care instructions from the surface manufacturer.

When cleaning finished wood surfaces, use broad, continuous cleaning strokes. To prevent surface damage, avoid focusing steam or allowing the cleaning tools to sit in one spot for any amount of time.

When assembling your portable steam cleaner, there may be a little water in the water tank. This is because we test all our portable steam cleaners 100% before you buy them, so you get a quality Shark® Steam product.

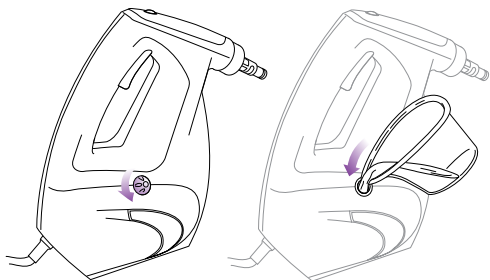

1 FILL

Turn the water tank cap counter-clockwise and remove to fill, using the filling flask provided. Be careful not to overflow. Replace the cap by turning clockwise. The water tank does not have to be completely full for the steam bottle to generate steam. Steam will stop when the water tank is empty. You can refill at any time.

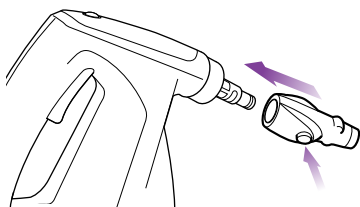

2 DIRECT SPRAY STEAM BOTTLE USE

Attach the concentrator nozzle by pressing the lock release buttons on the concentrator nozzle and slide onto the Steam Bottle nozzle. Press in and turn clockwise until the concentrator nozzle clicks into place.

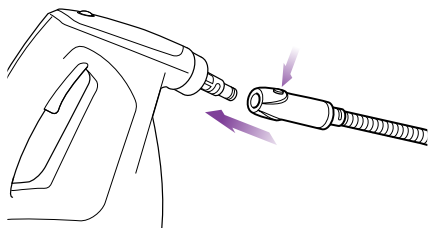

3 ATTACHING THE HOSE

Attach the hose connector by pressing the lock release buttons on the accessory hose and slide onto the Steam Bottle nozzle. Press in and turn clockwise until it clicks into place.

4 CLEANING TOOL ASSEMBLY

a Press fit the **grout scrubber brush** onto the accessory hose handle.

b Press fit the **window squeegee** onto the accessory hose handle.

c Press fit the **flat scrubbing tool** onto the accessory hose handle. Attach one of the scrubbing pads onto the scrubbing tool.

